

Control unit
module rear E-8000 W-100/W-200
115Vac / 230Vac
4.08.242 / 4.08.243

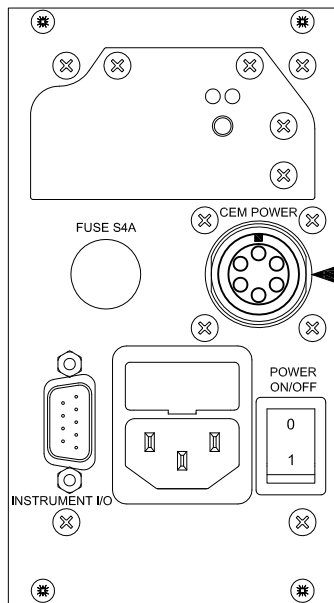

Amphenol
6-pin female
MS3102A-14S-6S-A23

solder-side
Amphenol
6-pin male
MS3106A-14S-6P-A23

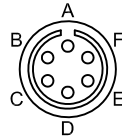

solder-side
Amphenol
6-pin female
MS3106A-14S-6S-A23

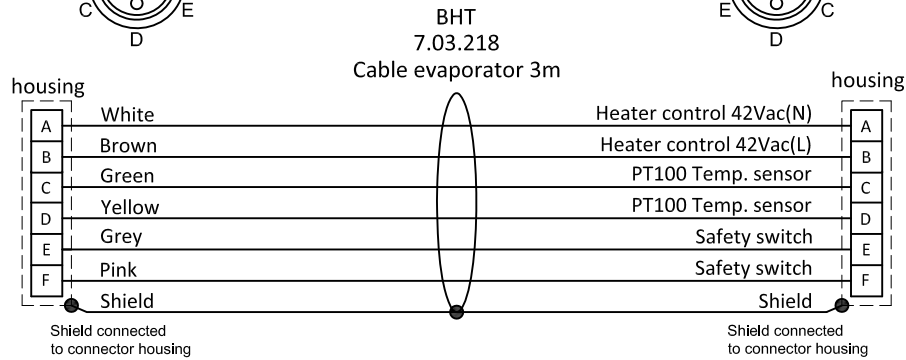
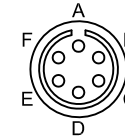

CEM
W-101A / W-102A / W-202A
7.01.880 / 7.01.881 / 7.01.882

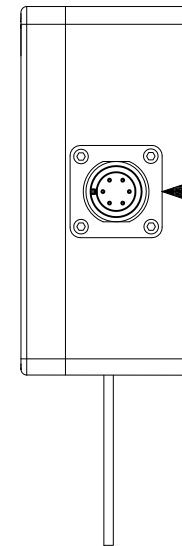

Amphenol
6-pin male
MS3102A-14S-6P-A23

Power supply
110...120Vac / 220...240Vac
50-60Hz
Power 160VA max.